



DNH^{AS}

**N-3770 Kragerø
NORWAY**
 Phone: (47) 35 98 56 00
 Fax: (47) 35 98 56 10
 E-mail: dnh@dnh.no
 Web-site: www.dnh.no

**DNH WW Ltd.
England**

Phone:.....(44) 1908 275 000
 Fax:.....(44) 1908 275 100
 E-mail:.....dnh@dnh.co.uk

**DNH GmbH
Germany**

Phone:.....(49) 040 6569 30-0
 Fax:.....(49) 040 6569 30-30
 E-mail:.....dnh@dnh.de

**DNH
Speakers Inc.
USA**

Phone:.....(1) 484 494 5790
 Fax:.....(1) 484 494 5793
 E-mail:.....dnh@dnhspeakers.com

ISO 9001 CERTIFIED

P3x2T

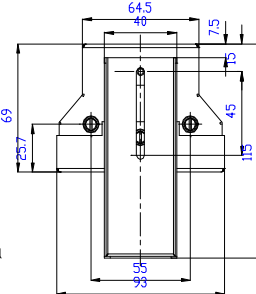
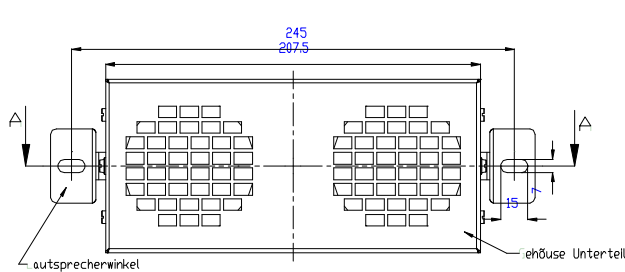

100 Volt Line

White-Yellow	: 15,0 W
Yellow-green	: 7,5 W
Green-Brown	: 3,5 W
White-Green	: 2,7 W
Yellow-Brown	: 1,3 W
White-Brown	: 0,8 W

1W/1m Sine Wave 1/3 octave bands

SPL vs Freq



Material / Colour Metal V 2A
 Mounting Bracket
 Termination Spring Clamp
 Weight 1,75 kg
 IP-rating
 Max. / min. amb. temp 150°C / - 20°C
 Standard version 4 Ω
 Rated / max. power 10 W / 15 W
 SPL 1W/1m 94 dB
 SPL rated power 104 dB
 Effective freq. range 180 – 20000 Hz
 Dispersion(-6dB)1kHz/4kHz 120°/33°&180°/120° Hor/Vert
 Directivity factor, Q

Installation, Operation and Maintenance Procedures

- When mounting the loudspeaker please ensure that it is re-assembled in the same manner in which it was received.
- For optimum performance, always use the correct voltage / power and operate within the frequency limits as stated.
- Do not open loudspeaker when energized.
- This loudspeaker fits in all LMT lightingsystems.
- This loudspeaker is supplied with a 2 year warranty against defective workmanship.

Most of our products are available in different colours, impedances and power ratings.

